

# Surface Mount LEDs

1206 Type 3.2mm(L) X 1.6mm(W) X 1.1mm(H)

IF=20mA Ta=25°C

Device No	Color		Wavelength (nm)		VF Typical (V)	Brightness (mcd)		View Angle 2θW
	Emitter	Lens	λp	λd		Minimum	Typical	
HCL-1502	hi-red	white diffused	700	658	2.20	0.8	1.25	140
HCL-1503	yellow green	white diffused	570	567	2.15	3.2	9.5	
HCL-1503BG	super yellow green	white diffused	575	572	2.20	20.0	45.0	
HCL-1503SG	standard green	white diffused	567	564	2.15	3.2	6.5	
HCL-1503PG	pure green	white diffused	557	555	2.20	1.0	3.5	
HCL-1503AG	super pure green	water clear	523	525	3.50	80.0	138	
HCL-1503BGA	super bluish green	white diffused	502	505	3.40	20.0	65	
HCL-1504	yellow	white diffused	589	585	2.10	3.0	6.5	
HCL-1504AY	super yellow	white diffused	589	588	2.00	28.0	45	
HCL-1504AYL	super yellow	white diffused	593	591	2.00	28.0	45	
HCL-1505	hi-eff red	white diffused	625	618	2.05	4.0	8.0	
HCL-1505AO	super orange	white diffused	620	615	2.00	28.0	55.0	
HCL-1505AOR	super fresh red	white diffused	635	626	2.00	28.0	45.0	
HCL-1506DR	super red	white diffused	660	643	1.80	7.0	17.0	
HCL-1506CR	super red	white diffused	660	643	1.80	12.0	25.0	
HCL-1506BR	super red	white diffused	655	638	2.10	15.0	25.0	
HCL-1507	amber	white diffused	610	606	2.05	3.0	6.0	
HCL-1507AA	super amber	white diffused	607	605	2.00	25.0	65.0	
HCL-1508CB	super blue	white diffused	468	470	3.80	20.0	35.0	
HCL-1508AB	super blue	water clear	465	470	3.50	28.0	48.0	
HCL-1509CW	super white	water clear	---	---	3.80	25.0	50.0	

Dimension:

Unit : mm. Tolerance:0.2mm.

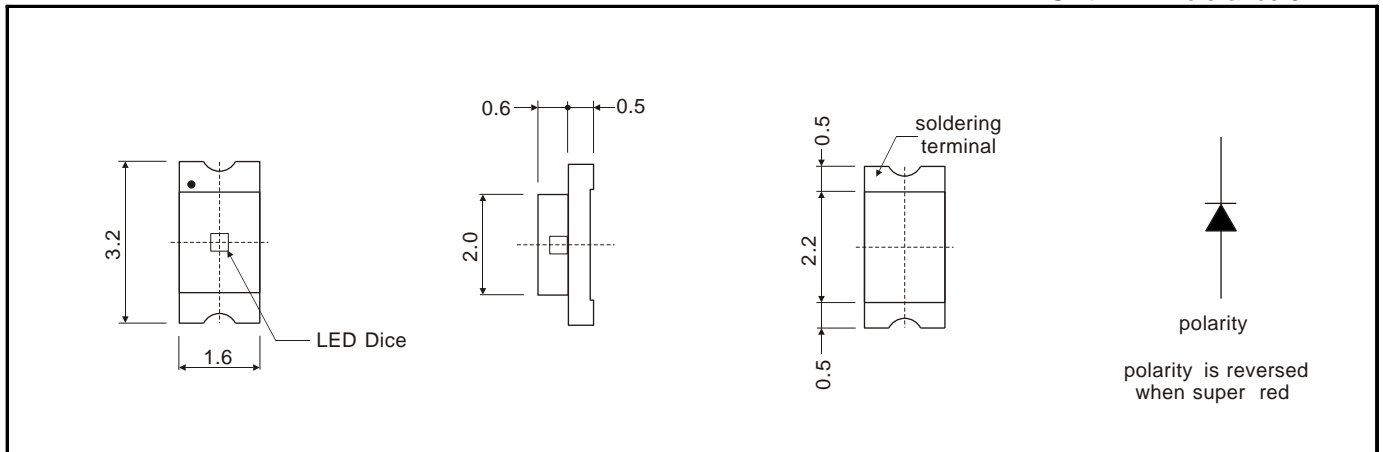

Recommended Soldering Pattern:

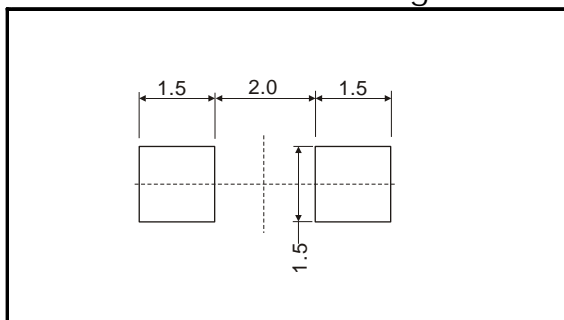

Tape Specifications: ( 3,000pcs/Reel )

