

PIEZO TRANSDUCERS

EXTERNAL DRIVE TYPE

DIMENSIONS



color Black
ABS Housing Material
Leadwire Terminal

Top View

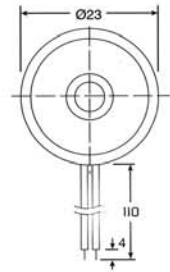

ELTDB01A

ELECTRICAL SPECIFICATIONS

Model No.	ELT5IPZ23500
Sound Pressure Level	70 dBA min. (12V p-p square wave, 30cm, 5000Hz)
Current	5 mA max. at 5000Hz
Capacitance	15000 pF ± 30% at 120Hz
Max. Input Voltage	40V p-p
Operating Temperature	-20 ~ +60°C
Weight	2 g

Side View

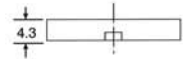

all dimensions are in mm

DIMENSIONS

Top View



color Black
ABS Housing Material
Leadwire Terminal

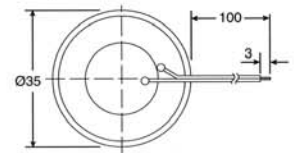

Side View



ELECTRICAL SPECIFICATIONS

Model No.	ELT52PZ35100
Sound Pressure Level	75 dBA min. (12V p-p square wave, 10cm, 1300Hz)
Current	7 mA max. at 1300Hz
Capacitance	45000 pF ± 30% at 120Hz
Input Voltage	40V p-p
Operating Temperature	-20 ~ +80°C
Weight	1.8 g

all dimensions are in mm