

# PIEZO TRANSDUCERS

## SELF DRIVE TYPE

### DIMENSIONS

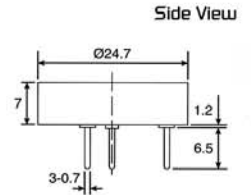
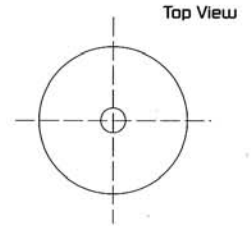

color Blue  
ABS Housing Material  
Pin Terminal

### ELECTRICAL SPECIFICATIONS

Model No.	ELT76PZ5680
Sound Pressure Level	90 dBA min. at 12 VDC, 10 cm
Frequency	6800±700Hz
Rated Voltage	12 VDC
Current	18 mA max.
Operating Temperature	-20 ~ +70°C
Weight	2.5 g

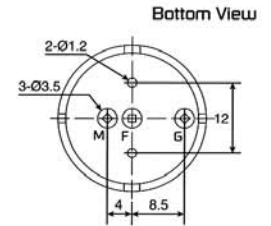

all dimensions are in mm

### DIMENSIONS

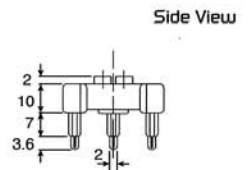
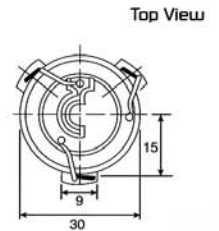

color Black  
PBT Housing Material  
Pin Terminal

### ELECTRICAL SPECIFICATIONS

Model No.	ELT87PZ30270
Sound Pressure Level	75 dBA min. at 3.0 V, 100 cm
Resonant Frequency	2700±500Hz
Rated Voltage	3 VDC
Capacitance	55nF ± 30% (G-M)
Operating Temperature	0 ~ +120°C
Weight	5 g

